

BUILDING FOUNDATION
PREPARATION:

AFTER STRIPPING THE SITE, THE BUILDING PAD SHOULD BE CUT TO AN ELEVATION WHICH ALLOWS THE PLACEMENT OF AT LEAST TWO FEET OF DENSITY APPROVED SELECT FILL BELOW THE FINAL SUBGRADE ELEVATION FOR THE FLOOR SLAB. THE SLAB CUSHION MATERIAL SHOULD NOT BE CONSIDERED AS A PORTION OF THE SELECT FILL THICKNESS. THE SELECT FILL BUILDING PAD SHOULD EXTEND AT LEAST FIVE FEET BEYOND THE EDGE OF THE BUILDING. AFTER TO SUBGRADE HAS BEEN PREPARED AND INSPECTED, FILL PLACEMENT MAY BEGIN. SELECT FILL MATERIAL SHOULD BE FREE OF ORGANIC OR OTHER DELETERIOUS MATERIALS, HOMOGENEOUS MIXTURE, HAVE A MAXIMUM PARTICLE SIZE OF THREE INCHES, HAVE A LIQUID LIMIT LESS THAN 40 AND PLASTICITY INDEX BETWEEN 8 AND 20, AND CONSIST OF SILTY-CLAYEY SANDS (SM-SC), LOW PLASTICITY SANDY CLAYS (CL) OR CLAYEY SANDS (SC) AS DEFINED BY THE UNIFIED SOIL CLASSIFICATION SYSTEM. IN ADDITION TO THE ABOVE REQUIREMENTS, THE MATERIALS SHOULD HAVE A MINIMUM OF 30 PERCENT RETAINED ON THE NO 200 SIEVE. IF A FINE-GRAINED MATERIAL IS USED FOR FILL, VERY CLOSE MOISTURE CONTENT CONTROL WILL BE REQUIRED TO ACHIEVE THE RECOMMENDED DEGREE OF COMPACTION.

- KEYED NOTES:

- | | |
|----|--|
| 01 | PROVIDE RECEPTACLE IN WALL CABINET FOR MICROWAVE. |
| 02 | PROVIDE POWER AS REQUIRED FOR RANGE HOOD. |
| 03 | PROVIDE POWER AS REQUIRED FOR HVAC SYSTEM AND WATER HEATER IN ATTIC. |
| 04 | 4" CONCRETE SLAB ON GRADE. |
| 05 | 6 x 6 - W1.4 x W1.4 WWF. |
| 06 | 4" COMPACTED GRANULAR FILL WITH TOP CHOCKED OFF WITH SAND. |
| 07 | 10 MIL VAPOR BARRIER. |
| 08 | 1/2"Ø ANCHOR BOLTS (GALVANIZED G-90) AT 72" ON CENTER. |
| 09 | 3" TIES AT 72" ON CENTER. |
| 10 | 2#5'S CONTINUOUS AT TOP AND BOTTOM. |
| 11 | 2x4 EXTERIOR TREATED SILL PLATE WITH SILL GASKET. |
| 12 | 2#5'S CONTINUOUS AT BOTTOM. |

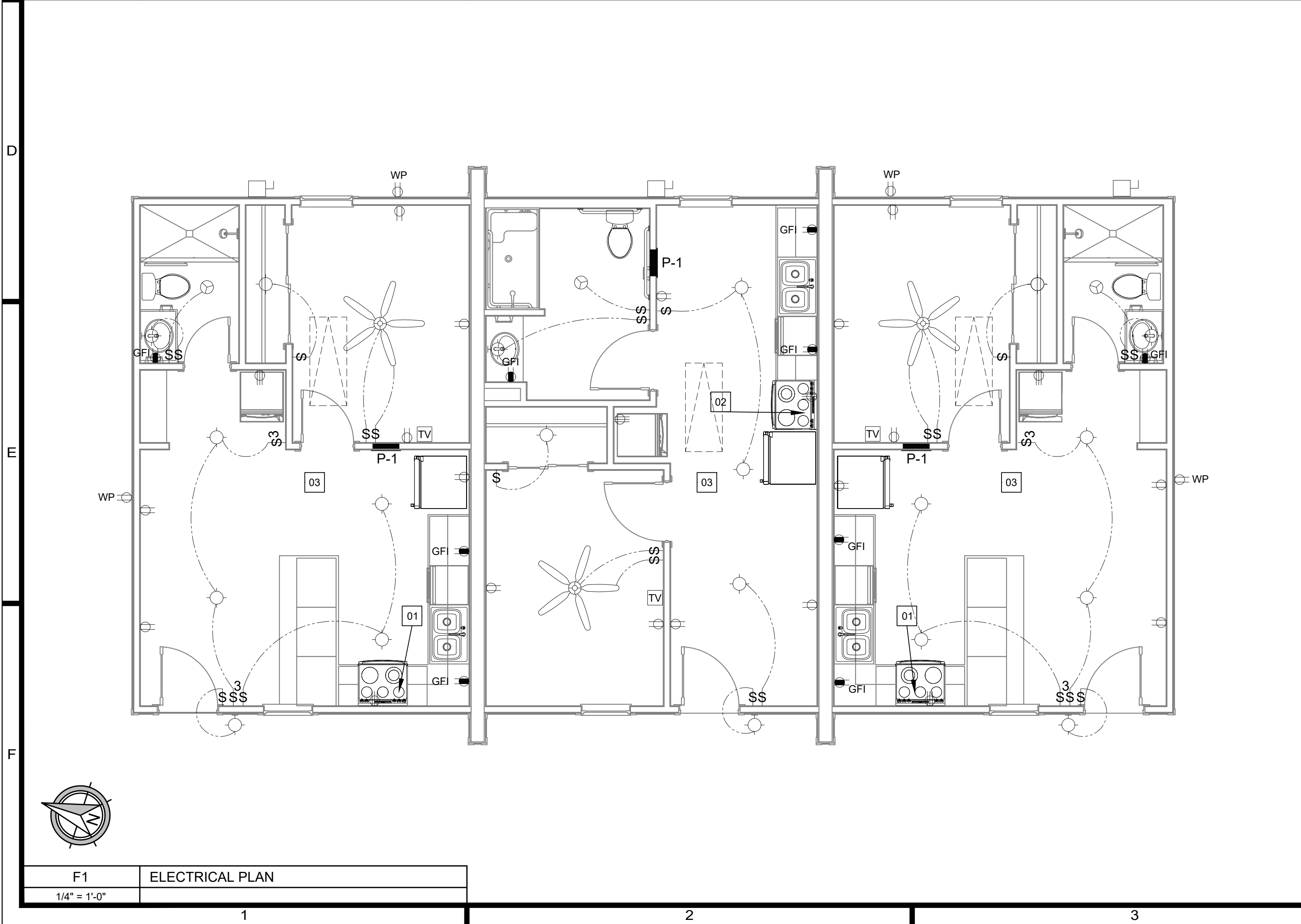

PANEL P1 – DWELLING UNIT
LOCATION: APARTMENT (INTERIOR)
SERVICE: 120/240V, 1Ø, 3W, 100A MCB, 30-SPACE

CKT	POLES	RATING	DESCRIPTION	LOAD
1	1	20A	SMALL APPLIANCE CIRCUIT #1	1500 VA
3	1	20A	SMALL APPLIANCE CIRCUIT #2	1500 VA
5	1	20A	REFRIGERATOR	600 VA
7	1	15A	LIGHTING / GEN. RECEPTS #1	800 VA
9	1	15A	LIGHTING / GEN. RECEPTS #2	800 VA
11	1	20A	BATH GFCI RECEPT	600 VA
13	1	20A	LAUNDRY (WASHER)	1500 VA
15	1	20A	DISHWASHER	1200 VA
17	1	20A	MICROWAVE	1200 VA
19	1	20A	BEDROOM / LIVING RECEPTS	800 VA
21	1	20A	SPARE / FUTURE	0 VA
23	1	20A	SPARE / FUTURE	0 VA
25	1	20A	SPARE / FUTURE	0 VA
27	1	20A	SPARE / FUTURE	0 VA
29	1	20A	SPARE / FUTURE	0 VA
2	2	40A	ELECTRIC RANGE	8000 VA
4	2	30A	STACKED ELECTRIC DRYER	5000 VA
6	2	30A	ELECTRIC WATER HEATER	4500 VA
8	2	25A	HVAC CONDENSER	2500 VA
10	2	60A	AIR HANDLER + HEAT STRIPS	10000 VA
12	2	20A	SPARE / FUTURE 2P	0 VA
14	2	20A	SPARE / FUTURE 2P	0 VA
16	2	20A	SPARE / FUTURE 2P	0 VA
18	2	20A	SPARE / FUTURE 2P	0 VA

NOTES:

1. ALL 120V DWELLING CIRCUITS AFCI/GFCI AS REQUIRED BY NEC.
2. HVAC BREAKER SIZES TO MATCH NAMEPLATE MCA/MOCP (ADJUST 25A/60A AS NEEDED).
3. PANEL P1: 30-SPACE, 100A MAIN BREAKER, 120/240V, 1Ø, 3W.